

The logo for impXray, featuring the word "imp" in white, a stylized orange and white "X" symbol, and the word "ray" in white.

True 17x17 Cassette Sized Flat Panel Detector

The **impXray** is a cassette type detector that provides a wider active area for an image, and a versatile and reliable imaging solution for your diagnostic needs. With a full field of view of 17" x 17" (43 cm x 43 cm), it can cover a very comprehensive range of radiographic applications. Its 15 mm thickness allows you to experience true flat panel digital imaging technology without modifying the existing cassette bucky tray. The **impXray** is an ideal and economical digital solution designed to meet your radiology department requirements.

Application

- General Radiography
- Chiropractic
- Orthopedics
- Veterinary

Feature

- Cassette Sized Flat Panel Detector
- Auto-triggering Technology
- Improved Workflow through Immediate Image Capture
- Wide Image Area, Significantly Reduced Dead Space



True 17x17 Cassette Sized Flat Panel Detector

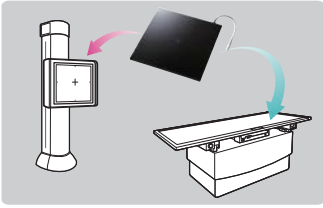

Upgrade to True Digital Flat Panel Technology

The **impXray** Series gives users the opportunity to experience True Flat Panel Digital Imaging Technology without any modifications to X-ray equipment. By having the same 15 mm thickness as traditional film screen cassettes, this lightweight detector fits into existing standard cassette trays, allowing existing film or CR systems to be easily upgraded. Its advanced auto-triggering technology now eliminates the need to integrate with the X-ray generator. The 1717 Series is a universal and economical solution designed to meet any X-ray department's needs.

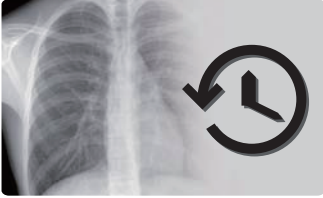

Improved Workflow through Immediate Image Capture

Using the **impXray** will increase workflow while minimizing labor time by avoiding additional steps that are required when using film processors or CR digitizers. Image preview time is reduced to just 1.5 seconds, which not only helps finalize the final body position, but it increases patient comfort by eliminating the need for them to remain in uncomfortable conditions. The instant display of images significantly increases productivity while reducing the wait time for both patients and staff.



Wide Image Area, Significantly Reduced Dead Space

Unlike traditional film and CR cassette sizes (14" x 17"), adopting a full field of view providing a 17" x 17" usable area gives more flexibility with positioning and allows more regions of anatomy to be acquired on one image without the need to rotate the detector. With the dead space percentage being significantly reduced, the **impXray** leads to optimized efficiency without any wasted image area.

Specification

Sensor	
Panel	Amorphous Silicon with TFT
Scintillator	CsI:Tl(SCN)
Pixel Pitch	139µm
Pixel Matrix	3,072 x 3,072
Electronics	
A/D Conversion	14bit / 16bit
Data Acquisition Time	<1.5 sec (preview) <5 sec (display)
Data Interface	Gigabit Ethernet

Performance	
DQE (0 lp/mm)	Typ.78% (SCN) / Typ.48% (SGN)
MTF (1 lp/mm)	Typ.58%
Limiting Resolution	Max. 3.5lp/mm
Energy Range	40 ~ 150kVp
Mechanical	
Size	460 × 460 × 15.5 mm
Weight	4kg
Housing	Al
Operation Environment	5~40°C, 30~75%RH (non-condensing)
Storage & Transport Environment	-10~55°C, 10~80%RH (non-condensing)

Interface

□ System1(Single Detector)

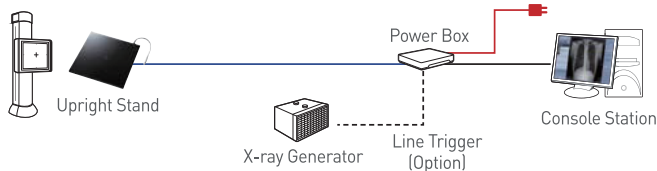

□ System2(Dual Detectors)

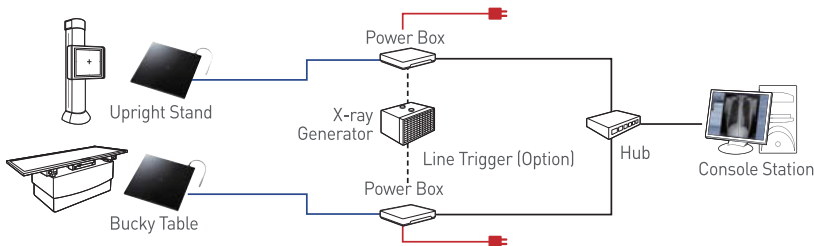

Dimensions

